

**MATERIAL**

Aluminium, matte finish.  
AISI 304 stainless steel screws and nuts.

**STANDARD EXECUTIONS**

- **GN 166-B**: for round tubes.
  - **GN 166-V**: for square tubes.
- Surface finish index:
- **BL**: natural colour.
  - **SW**: epoxy resin coating resistant to UV rays, RAL 9005 black colour.

**FEATURES AND APPLICATIONS**

The assembly hole of GN 165 connecting clamps allows an excellent match with tubes GN 990 (see page 1368).  
The clamping screw d3 may be replaced by clamping kit GN 911 (see page 1372).

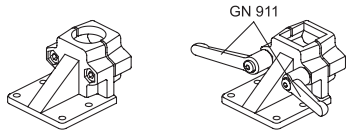

d1	
mm	inch
20	0.78
25	0.98
30	1.17
40	1.56
42	1.64
45	1.76
48	1.87
50	1.95
60	2.34

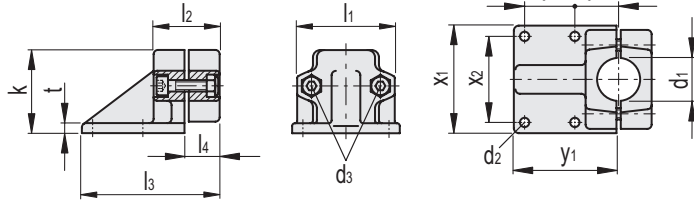

**GN 166-B**

Code	Description	d1 Hole	d2	d3	k	l1	l2	l3	l4	t	x1	x2	y1	y2	y3	d3 Clamping kit	⚖️
GN.49611	GN 166-B20-2-BL	20	7	M8	58	69	46	96	23	7	75	60	72	35	30	GN 911-63-M8-40 GN 911-78-M8-40	297
GN.49631	GN 166-B25-2-BL	25	7	M8	58	69	46	96	23	7	75	60	72	35	30	GN 911-63-M8-40 GN 911-78-M8-40	291
GN.49651	GN 166-B30-2-BL	30	7	M8	58	69	46	96	23	7	75	60	72	35	30	GN 911-63-M8-40 GN 911-78-M8-40	286
GN.49671	GN 166-B40-2-BL	40	11	M10	91	98	70	145	35	14	115	90	108	50	45	GN 911-78-M10-78 GN 911-92-M10-92	870
GN.49691	GN 166-B42-2-BL	42	11	M10	91	98	70	145	35	14	115	90	108	50	45	GN 911-78-M10-78 GN 911-92-M10-92	850
GN.49711	GN 166-B45-2-BL	45	11	M10	91	98	70	145	35	14	115	90	108	50	45	GN 911-78-M10-78 GN 911-92-M10-92	840
GN.49731	GN 166-B48-2-BL	48	11	M10	91	98	70	145	35	14	115	90	108	50	45	GN 911-78-M10-78 GN 911-92-M10-92	830
GN.49751	GN 166-B50-2-BL	50	11	M10	91	98	70	145	35	14	115	90	108	50	45	GN 911-78-M10-78 GN 911-92-M10-92	815
GN.49761	GN 166-B60-2-BL	60	11	M10	100	108.5	83	172	42	14	125	100	128	52	65.5	-	805
GN.49616	GN 166-B20-2-SW	20	7	M8	58	69	46	96	23	7	75	60	72	35	30	GN 911-63-M8-40 GN 911-78-M8-40	297
GN.49636	GN 166-B25-2-SW	25	7	M8	58	69	46	96	23	7	75	60	72	35	30	GN 911-63-M8-40 GN 911-78-M8-40	291
GN.49656	GN 166-B30-2-SW	30	7	M8	58	69	46	96	23	7	75	60	72	35	30	GN 911-63-M8-40 GN 911-78-M8-40	286
GN.49676	GN 166-B40-2-SW	40	11	M10	91	98	70	145	35	14	115	90	108	50	45	GN 911-78-M10-78 GN 911-92-M10-92	870
GN.49696	GN 166-B42-2-SW	42	11	M10	91	98	70	145	35	14	115	90	108	50	45	GN 911-78-M10-78 GN 911-92-M10-92	850
GN.49716	GN 166-B45-2-SW	45	11	M10	91	98	70	145	35	14	115	90	108	50	45	GN 911-78-M10-78 GN 911-92-M10-92	840
GN.49736	GN 166-B48-2-SW	48	11	M10	91	98	70	145	35	14	115	90	108	50	45	GN 911-78-M10-78 GN 911-92-M10-92	830
GN.49756	GN 166-B50-2-SW	50	11	M10	91	98	70	145	35	14	115	90	108	50	45	GN 911-78-M10-78 GN 911-92-M10-92	815
GN.49762	GN 166-B60-2-SW	60	11	M10	100	108.5	83	172	42	14	125	100	128	52	65.5	-	805

Tube connectors

Conversion Table 1 mm = 0.039 inch	
s	
mm	inch
20	0.78
25	0.98
30	1.17
40	1.56
45	1.76
50	1.95
60	2.34

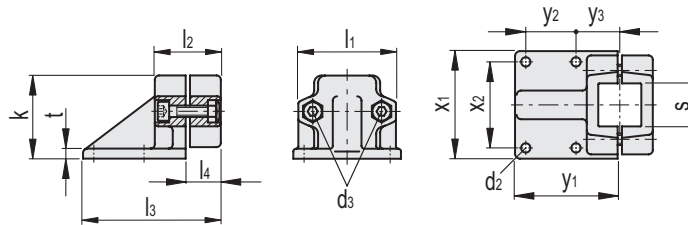

GN 166-V

METRIC

Code	Description	s Square hole	d2	d3	k	l1	l2	l3	l4	t	x1	x2	y1	y2	y3	d3 Clamping kit	⚖
GN.49811	GN 166-V20-2-BL	20x20	7	M8	58	69	46	96	23	7	75	60	72	35	30	GN 911-63-M8-40 GN 911-78-M8-40	290
GN.49831	GN 166-V25-2-BL	25x25	7	M8	58	69	46	96	23	7	75	60	72	35	30	GN 911-63-M8-40 GN 911-78-M8-40	250
GN.49851	GN 166-V30-2-BL	30x30	7	M8	58	69	46	96	23	7	75	60	72	35	30	GN 911-63-M8-40 GN 911-78-M8-40	190
GN.49871	GN 166-V40-2-BL	40x40	11	M10	91	98	70	145	35	14	115	90	108	50	45	GN 911-78-M10-78 GN 911-92-M10-92	900
GN.49891	GN 166-V45-2-BL	45x45	11	M10	91	98	70	145	35	14	115	90	108	50	45	GN 911-78-M10-78 GN 911-92-M10-92	815
GN.49911	GN 166-V50-2-BL	50x50	11	M10	91	98	70	145	35	14	115	90	108	50	45	GN 911-78-M10-78 GN 911-92-M10-92	776
GN.49921	GN 166-V60-2-BL	60x60	11	M10	100	108.5	83	172	42	14	125	100	128	52	65.5	-	745
GN.49816	GN 166-V20-2-SW	20x20	7	M8	58	69	46	96	23	7	75	60	72	35	30	GN 911-63-M8-40 GN 911-78-M8-40	290
GN.49836	GN 166-V25-2-SW	25x25	7	M8	58	69	46	96	23	7	75	60	72	35	30	GN 911-63-M8-40 GN 911-78-M8-40	250
GN.49856	GN 166-V30-2-SW	30x30	7	M8	58	69	46	96	23	7	75	60	72	35	30	GN 911-63-M8-40 GN 911-78-M8-40	190
GN.49876	GN 166-V40-2-SW	40x40	11	M10	91	98	70	145	35	14	115	90	108	50	45	GN 911-78-M10-78 GN 911-92-M10-92	900
GN.49896	GN 166-V45-2-SW	45x45	11	M10	91	98	70	145	35	14	115	90	108	50	45	GN 911-78-M10-78 GN 911-92-M10-92	815
GN.49916	GN 166-V50-2-SW	50x50	11	M10	91	98	70	145	35	14	115	90	108	50	45	GN 911-78-M10-78 GN 911-92-M10-92	776
GN.49922	GN 166-V60-2-SW	60x60	11	M10	100	108.5	83	172	42	14	125	100	128	52	65.5	-	745



Tube connectors